

*Instrument
Pipe Fittings
& Adapter*

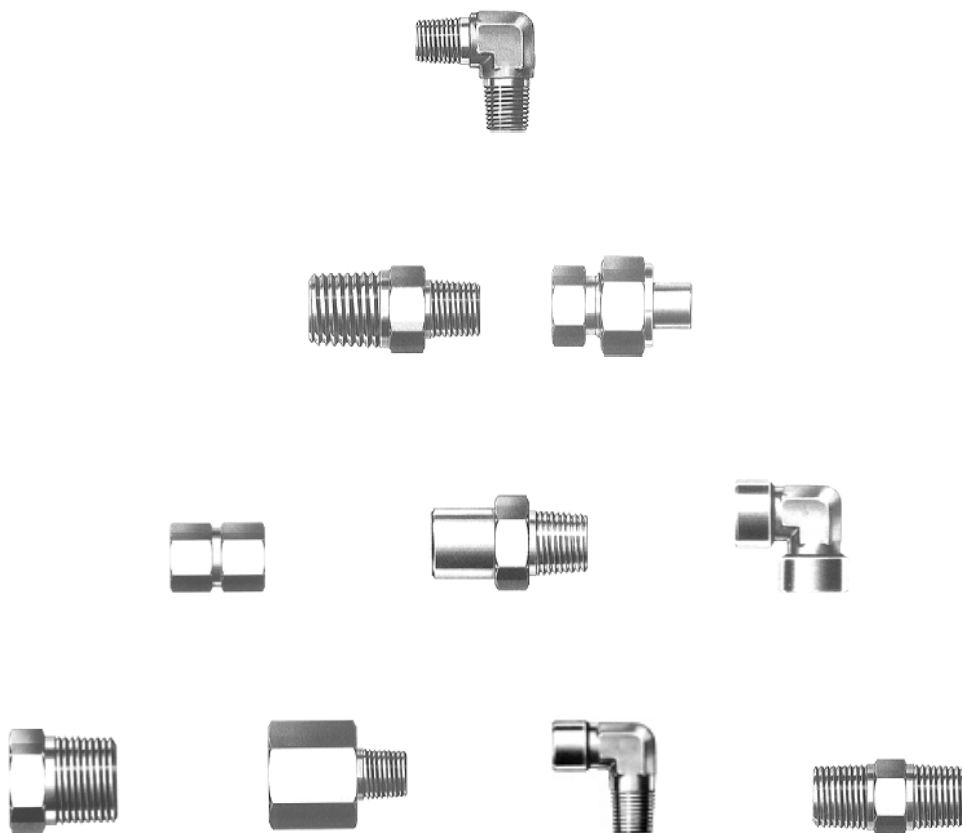

- Available in 1/16" to 2"
- Material - SS 316, Carbon Steel, Brass
- Thread - NPT, ISO/BSP, SAE

Introduction

Comfit Instrument pipe fittings and adapters are designed and manufactured to very close tolerances & leakfree connections for process, power, instrumentation and general plumbing applications, under rigid quality control procedures approved to ISO 9001:2000

Features

- 1) Sizes from 1/16" through 2".
- 2) Working pressures calculated in accordance with power piping code ANSI B31.1 and refinery piping code ANSI B31.3.
- 3) Male Thread are protected with plastic cap.
- 4) Materials :

Material	Bar Stock	Forgings
SS316	ASTM A479 ASTM A276	ASTM A182
Brass	ASTM B16, ASTM B453	ASTM B283
Carbon Steel	ASTM A108	-----

- 5) Thread Standard :

End Connection	Specification
NPT	ASME B1.20.1, SAE AS71051
ISO/BSP (parallel)	ISO 228, JIS B0202
ISO/BSP (tapered)	ISO 7/1, BS EN 10226-1
ISO/BSP (gauge) (Based on EN 837-1 AND 837-3)	ISO 228, JIS B0202
Unified (SAE/MS)	ASME B1.1
Socketweld	ASME B16.11

- 6) Gasket O-ring Materials :







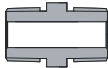
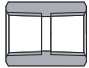
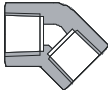

Component	Material	Maximum Temperature °F (°C)	Minimum Temperature °F (°C)
RS gaskets	Buna N	230 (110)	-13 (-25)
	Fluorocarbon FKM	400 (204)	5 (-15)
RG, RP Gaskets	Copper	400 (204)	-325 (-198)
SAE O-ring	Fluorocarbon FKM		-20 (-28)

Pressure Ratings

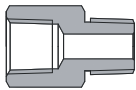
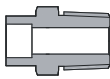
NPT/ISO Pipe Size	Size	SS 316				Brass				Carbon Steel			
		Male		Female		Male		Female		Male		Female	
		Psig	Bar	Psig	Bar	Psig	Bar	Psig	Bar	Psig	Bar	Psig	Bar
1/16"	1	11000	757	6700	461	5500	378	3300	227	11000	757	6700	461
1/8"	2	10000	689	6500	447	5000	344	3200	220	10000	689	6500	447
1/4"	4	8000	551	6600	454	4000	275	3300	227	8000	551	6600	454
3/8"	6	7800	537	5300	365	3900	265	2600	179	7800	537	5300	365
1/2"	8	7700	530	4900	337	3800	261	2400	165	7700	530	4900	337
3/4"	12	7300	502	4600	316	3600	248	2300	158	7300	502	4600	316
1"	16	5300	365	4400	303	2600	179	2200	151	5300	365	4400	303
1-1/4"	20	6000	413	5000	344	3000	206	2500	172	6000	413	5000	344
1-1/2"	24	5000	344	4600	316	2500	172	2300	158	5000	344	4600	316
2"	32	3900	268	3900	268	1900	130	1900	130	3900	268	3900	268

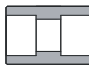
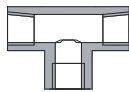
- Working pressure calculated are reference only.
- Working pressure calculated as per Piping code ANSI B31.3 with allowable stress 20,000 psi/SS316, 10,000 psi/Brass, 20,000 psi/Carbon Steel and for working pressure in accordance with Power Piping Code B31.1 simply calculate applying a factor of .94 (94%) to above chart.
- Due to larger outer diameter female threads pressure ratings of female are lower than male threads.
- To determine kPa, multiply psig by 6.89
- Pressure ratings of Hex Bushing (H-SHB) are not covered with this pressure rating table therefore indicated its dimensional table.

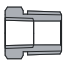
.....INDEX....for Instrument Pipe Fittings & Adapter

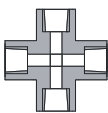
Straight Fittings	Couplings	45° Elbow Fittings	Accessories
<p>Nipples</p>  <p>Close Nipples</p> <ul style="list-style-type: none"> • NPT(M) x NPT(M).....pg.05 <p>Hex Nipples</p> <ul style="list-style-type: none"> • NPT(M) x NPT(M)..... pg.06 • ISOT(M) x ISOT(M)..... pg.07 • NPT(M) x ISOT(M)..... pg.08 • NPT(M) x ISOP(M)-RS..pg.09 • NPT(M) x SAE/MS(M)..pg.10 <p>Hex Reducing Nipple</p> <ul style="list-style-type: none"> • NPT(M) x NPT(M)..... pg.11 <p>Hex Long Nipples</p> <ul style="list-style-type: none"> • NPT(M) x NPT(M)..... pg.12 	<p>Couplings</p>  <p>Hex Couplings</p> <ul style="list-style-type: none"> • NPT(F) x NPT(F)..... pg.27 • ISOT(F) x ISOT(F)..... pg.28 <p>Hex Reducing Couplings</p> <ul style="list-style-type: none"> • NPT(F) x NPT(F)..... pg.29 • ISOT(F) x ISOT(F)..... pg.30 	<p>45° Elbows</p>  <p>45° Female Elbow</p> <ul style="list-style-type: none"> • NPT(F) x NPT(F)..... pg.43 <p>45° Street Elbow</p> <ul style="list-style-type: none"> • NPT(M) x NPT(F)..... pg.44 	<p>Union Ball Joint</p>  <p>Union Ball Joint</p> <ul style="list-style-type: none"> • NPT(F) x NPT(F).... pg.53
<p>Adapters</p>  <p>Adapters</p> <ul style="list-style-type: none"> • NPT(M) x NPT(F)..... pg.13 • ISOT(M) x ISOT(F)..... pg.14 • NPT(F) x ISOT(M)..... pg.15 • ISOT(F) x NPT(M)..... pg.16 • NPT(F) x ISOP(M)..... pg.17 	<p>Connectors</p>  <p>Male Connectors</p> <ul style="list-style-type: none"> • FT SW x NPT(M)..... pg.31 <p>Female Connectors</p> <ul style="list-style-type: none"> • FT SW x NPT(F)..... pg.32 	<p>Tee Fittings</p>	<p>Caps</p>  <p>Hex Female Pipe Cap</p> <ul style="list-style-type: none"> • NPT(F)..... pg.54
<p>Reducing Adapters</p> <ul style="list-style-type: none"> • NPT(F) x NPT(M)..... pg.18 • ISOT(F) x ISOT(M)..... pg.19 • Tube BW or Tube SW x Tube SW..... pg.20 • Pipe BW or Pipe SW x Tube SW..... pg.21 	<p>Unions</p>  <p>Tube Unions</p> <ul style="list-style-type: none"> • FT SW..... pg.33 <p>Pipe Unions</p> <ul style="list-style-type: none"> • Pipe SW..... pg.34 	<p>Tees</p>  <p>Female Tees</p> <ul style="list-style-type: none"> • NPT(F)..... pg.45 • ISOT(F)..... pg.46 <p>Street Tees</p> <ul style="list-style-type: none"> • NPT(F) x NPT(M) x NPT(F)..... pg.47 	<p>Plugs</p>  <p>Hex male Plug</p> <ul style="list-style-type: none"> • NPT(M)..... pg.55
<p>SAE-Adapters</p> <ul style="list-style-type: none"> • SAE/MS(M) x SAE/MS(F)..pg.22 • SAE/MS(M) x NPT(F)..pg.23 <p>Gauge Adapter</p> <ul style="list-style-type: none"> • ISOP(F) x NPT(M).....pg.24 	<p>90° Elbow fittings</p>	<p>Branch Tees</p> <ul style="list-style-type: none"> • NPT(F) x NPT(F) x NPT(M)..... pg.48 <p>Male Tees</p> <ul style="list-style-type: none"> • NPT(M) x NPT(M) x NPT(M)..... pg.49 <p>Union Tees</p> <ul style="list-style-type: none"> • FT SW..... pg.50 	<p>Allen plug</p> <ul style="list-style-type: none"> • NPT(M)..... pg.56 <p>Hex SAE Plug</p> <ul style="list-style-type: none"> • SAE/MS(M)..... pg.57 <p>Allen SAE Plug</p> <ul style="list-style-type: none"> • SAE/MS(M)..... pg.58 <p>Hex Pipe Plug</p> <ul style="list-style-type: none"> • ISOT(F)..... pg.59 <p>Hex Pipe Plug-RS</p> <ul style="list-style-type: none"> • ISOP(M)..... pg.60
<p>Bushings</p>  <p>Reducing Bushings</p> <ul style="list-style-type: none"> • NPT(M) x NPT(F)..... pg.25 • ISOT(M) x ISOT(F).....pg.26 	<p>Elbows</p>  <p>Female Elbow</p> <ul style="list-style-type: none"> • NPT(F) x NPT(F)..... pg.35 • ISOT(F) x ISOT(F)..... pg.36 • FT SW x NPT(F)..... pg.37 <p>Street Elbow</p> <ul style="list-style-type: none"> • NPT(M) x NPT(F)..... pg.38 <p>Reducing Street Elbow</p> <ul style="list-style-type: none"> • NPT(M) x NPT(F)..... pg.39 <p>Male Elbow</p> <ul style="list-style-type: none"> • NPT(M) x NPT(M)..... pg.40 • FT SW x NPT(M)..... pg.41 <p>Union Elbow</p> <ul style="list-style-type: none"> • Fractional SW..... pg.42 	<p>Cross Fittings</p>	<p>Gaskets</p>  <ul style="list-style-type: none"> • RS..... pg.61 • RP..... pg.62 • RG..... pg.63
		<p>Female Cross</p>  <p>Female Cross</p> <ul style="list-style-type: none"> • NPT(F) x 4sides..... pg.51 <p>Union Cross</p> <ul style="list-style-type: none"> • FT SW ends pg.52 	

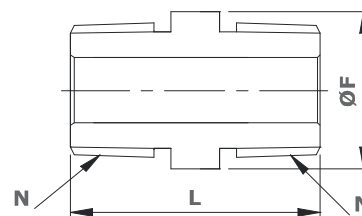

Close Nipple ___ NPT(M) x NPT(M)

COMFIT PRODUCT CODE	NPT MALE (N) (Dimensions in Inches)	LENGTH (L)	(ØF)
1N-CPCN	1/16x27	0.75	5/16
2N-CPCN	1/8x27	0.75	7/16
4N-CPCN	1/4x18	1.12	9/16
6N-CPCN	3/8x18	1.12	11/16
8N-CPCN	1/2x14	1.50	7/8
12N-CPCN	3/4x14	1.50	1-1/16
16N-CPCN	1x11.5	1.88	1-3/8

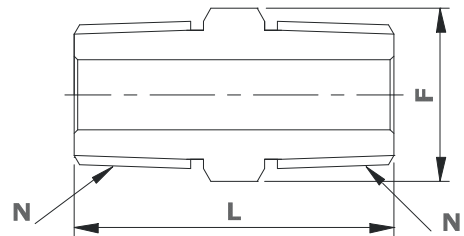

Hex Nipple __ NPT(M) x NPT(M)

COMFIT PRODUCT CODE	NPT MALE (N)	LENGTH (L)	HEX (F)
	(Dimensions in Inches)		
1N-CPHN	1/16x27	1.01	5/16
2N-CPHN	1/8x27	1.01	7/16
4N-CPHN	1/4x18	1.40	9/16
6N-CPHN	3/8x18	1.43	11/16
8N-CPHN	1/2x14	1.84	7/8
12N-CPHN	3/4x14	1.84	1-1/16
16N-CPHN	1x11.5	2.32	1-3/8
20N-CPHN	1-1/4x11.5	2.41	1-3/4
24N-CPHN	1-1/2x11.5	2.65	2-1/8
32N-CPHN	2x11.5	2.90	2-3/4

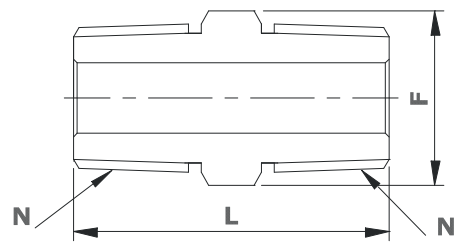

Hex Nipple__ISO(T(M) x ISO(T(M)

COMFIT PRODUCT CODE	ISO(BSPT) MALE (N) (Dimensions in Inches)	LENGTH (L)	HEX (F)
2IT-CPHN	1/8x28	1.01	7/16
4IT-CPHN	1/4x19	1.40	9/16
6IT-CPHN	3/8x19	1.43	11/16
8IT-CPHN	1/2x14	1.84	7/8

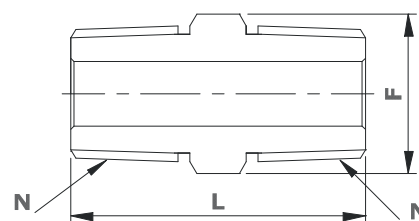

Hex Nipple__NPT(M) x ISOT(M)

COMFIT PRODUCT CODE	NPT MALE (N)	ISO MALE (N1)	LENGTH (L)	HEX (F)
(Dimensions in Inches)				
2N-CPHN-2IT	1/8x27	1/8x28	1.01	7/16
4N-CPHN-4IT	1/4x18	1/4x19	1.40	9/16
6N-CPHN-6IT	3/8x18	3/8x19	1.43	11/16
8N-CPHN-8IT	1/2x14	1/2x14	1.84	7/8
12N-CPHN-12IT	3/4x14	3/4x14	1.84	1-1/16
16N-CPHN-16IT	1x11.5	1x11	2.32	1-3/8

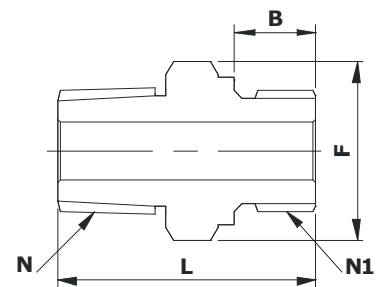

Hex Nipple-RS ___NPT(M) x ISOP(M)

COMFIT PRODUCT CODE	NPT MALE (N)	ISO MALE (N1)	LENGTH (L)	(B)	HEX (F)
(Dimensions in Inches)					
2N-CPHNRS-2IP	1/8x27	1/8x28	1.07	0.28	9/16
4N-CPHNRS-4IP	1/4x18	1/4x19	1.44	0.44	3/4
6N-CPHNRS-6IP	3/8x18	3/8x19	1.47	0.44	7/8
8N-CPHNRS-8IP	1/2x14	1/2x14	1.78	0.56	1-1/16
12N-CPHNRS-12IP	3/4x14	3/4x14	1.95	0.62	1-5/16
16N-CPHNRS-16IP	1x11.5	1x11	2.26	0.72	1-5/8

- 1) RS Fittings are supplied with Gasket seal (Gasket-RS) with male BSP(ISO) Parallel Threads.
It's consists of a fluorocarbon. FKM or Buna-N inner ring bonded to a carbon steel outer ring.

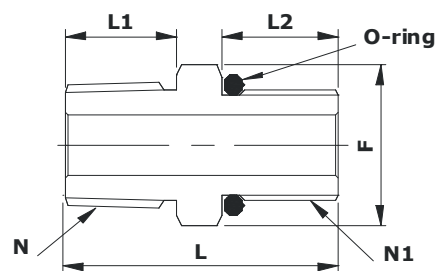

Hex Nipple__NPT(M) x SAE/MS(M)

COMFIT PRODUCT CODE	NPT MALE (N)	SAE/MS MALE (N1)	LENGTH (L)	LENGTH (L1)	LENGTH (L2)	HEX (F)
(Dimensions in Inches)						
4N-CPHN-4SM	1/4x18	7/16x20	1.20	0.56	0.35	9/16
6N-CPHN-6SM	3/8x18	9/16x18	1.26	0.56	0.39	11/16
8N-CPHN-8SM	1/2x14	3/4x16	1.53	0.75	0.44	7/8
12N-CPHN-17SM	3/4x14	1-1/16x12	1.75	0.75	0.59	1-1/4
16N-CPHN-21SM	1x11.5	1-5/16x12	2.00	0.94	0.59	1-1/2

- 1) Fittings are supplied with O’ring seal,
 * In Buna-N (Nitrile) as standard & Viton-optional.

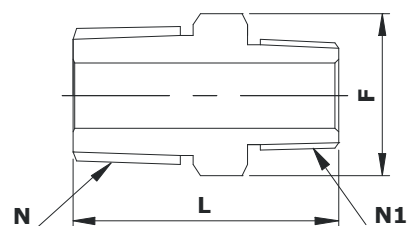

Hex Reducing Nipple ___ NPT(M) x NPT(M)

COMFIT PRODUCT CODE	NPT MALE (N)	NPT MALE (N1)	LENGTH (L)	HEX (F)
	(Dimensions in Inches)			
2-CPHRN-1N	1/8x27	1/16x27	1.01	7/16
4-CPHRN-1N	1/4x18	1/16x27	1.25	9/16
4-CPHRN-2N	1/4x18	1/8x27	1.22	9/16
6-CPHRN-1N	3/8x18	1/16x27	1.27	11/16
6-CPHRN-2N	3/8x18	1/8x27	1.25	11/16
6-CPHRN-4N	3/8x18	1/4x18	1.43	11/16
8-CPHRN-2N	1/2x14	1/8x27	1.47	7/8
8-CPHRN-4N	1/2x14	1/4x18	1.65	7/8
8-CPHRN-6N	1/2x14	3/8x18	1.65	7/8
12-CPHRN-2N	3/4x14	1/8x27	1.59	1-1/16
12-CPHRN-4N	3/4x14	1/4x18	1.65	1-1/16
12-CPHRN-6N	3/4x14	3/8x18	1.78	1-1/16
12-CPHRN-8N	3/4x14	1/2x14	1.84	1-1/16
16-CPHRN-2N	1x11.5	1/8x27	1.78	1-3/8
16-CPHRN-4N	1x11.5	1/4x18	1.97	1-3/8
16-CPHRN-8N	1x11.5	1/2x14	2.13	1-3/8
16-CPHRN-12N	1x11.5	3/4x14	2.13	1-3/8
20-CPHRN-16N	1-1/4x11.5	1x11.5	2.41	1-3/4
24-CPHRN-16N	1-1/2x11.5	1x11.5	2.56	2-1/8
32-CPHRN-16N	2x11.5	1x11.5	2.78	2-3/4

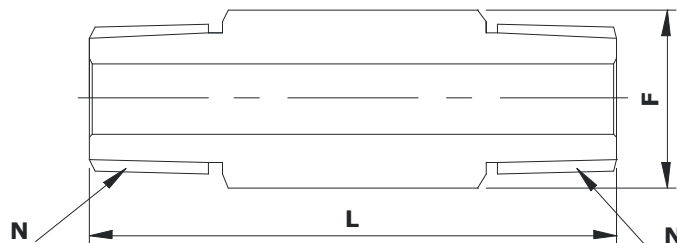

Hex Long Nipple __ NPT(M) x NPT(M)

COMFIT PRODUCT CODE	NPT Male Pipe Size (N)	(L)					Hex (F)
		Available Length					
		1.50	2.00	2.50	3.00	4.00	
(Dimensions in Inches)							
1N - CPHLN - (Y)	1/16x27	(Y)					7/16
2N - CPHLN	1/8x27	A	A	A	A	N/A	7/16
4N - CPHLN	1/4x18	A	A	A	A	A	9/16
6N - CPHLN	3/8x18	A	A	A	A	N/A	11/16
8N - CPHLN	1/2x14	N/A	A	N/A	A	A	7/8
12N - CPHLN	3/4x14	N/A	A	N/A	A	A	1-1/16
16N - CPHLN	1x11.5	N/A	N/A	N/A	A	A	1-3/8

- Specified length (Y) to be shown as last designator in the ordering number, example : 1N-CPHLN-6.00, A - Available, NA - Not available

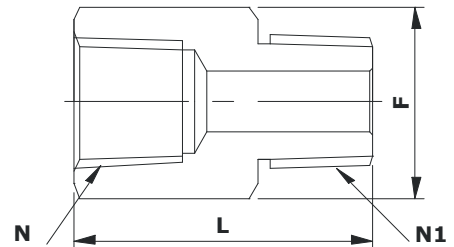

Adapter ___NPT(M) x NPT(F)

COMFIT PRODUCT CODE	NPT MALE (N)	NPT FEMALE (N1)	LENGTH (L)	HEX (F)
(Dimensions in Inches)				
2N-CPA	1/8x27	1/8x27	1.10	9/16
4N-CPA	1/4x18	1/4x18	1.40	3/4
6N-CPA	3/8x18	3/8x18	1.51	7/8
8N-CPA	1/2x14	1/2x14	1.94	1-1/16
12N-CPA	3/4x14	3/4x14	2.02	1-1/4
16N-CPA	1x11.5	1x11.5	2.28	1-5/8

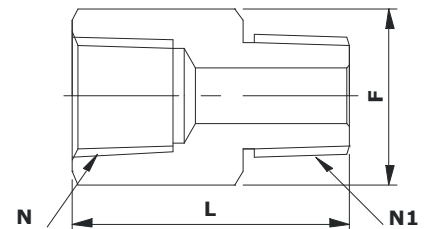

Adapter__ISOT(M) x ISOT(F)

COMFIT PRODUCT CODE	NPT MALE (N)	NPT FEMALE (N1)	LENGTH (L)	HEX (F)
(Dimensions in Inches)				
2IT-CPA	1/8 x 28	1/8 x 28	1.09	9/16
4IT-CPA	1/4 x 19	1/4 x 19	1.42	3/4
6IT-CPA	3/8 x 19	3/8 x 19	1.50	7/8
8IT-CPA	1/2 x 14	1/2 x 14	1.95	1-1/16

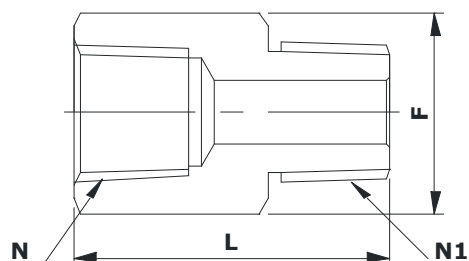

Adapter ___NPT(F) x ISOT(M)

COMFIT PRODUCT CODE	NPT FEMALE (N)	ISO(BSPT) MALE (N1)	LENGTH (L)	HEX (F)
(Dimensions in Inches)				
2N-CPA-2IT	1/8x27	1/8x28	1.09	9/16
4N-CPA-4IT	1/4x18	1/4x19	1.42	3/4
6N-CPA-6IT	3/8x18	3/8x19	1.50	7/8
8N-CPA-8IT	1/2x14	1/2x14	1.94	1-1/16
12N-CPA-12IT	3/4x14	3/4x14	2.02	1-1/4
16N-CPA-16IT	1x11.5	1x11	2.30	1-5/8

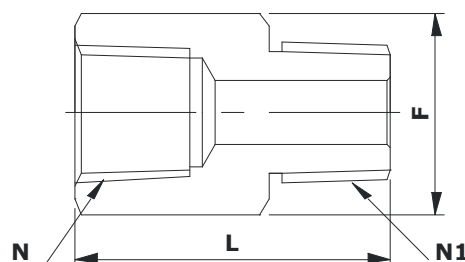

Adapter __ ISO(F) x NPT(M)

COMFIT PRODUCT CODE	ISO(BSPT) FEMALE (N)	NPT MALE (N1)	LENGTH (L)	HEX (F)
(Dimensions in Inches)				
2IT-CPA-2N	1/8x28	1/8x27	1.09	9/16
4IT-CPA-4N	1/4x19	1/4x18	1.43	3/4
6IT-CPA-6N	3/8x19	3/8x18	1.51	7/8
8IT-CPA-8N	1/2x14	1/2x14	1.96	1-1/16
12IT-CPA-12N	3/4x14	3/4x14	2.00	1-1/4
16IT-CPA-16N	1x11	1x11.5	2.28	1-5/8

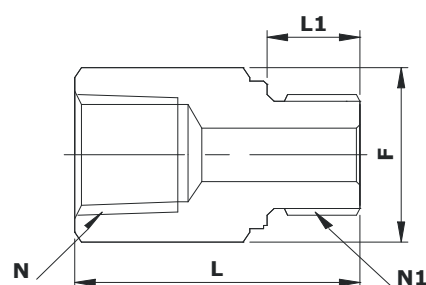

Adapter-RS__NPT(F) x ISOP(M)

COMFIT PRODUCT CODE	NPT FEMALE (N)	ISO(BSP) MALE (N1)	LENGTH (L)	HEX (F)	LENGTH (L1)
(Dimensions in Inches)					
2N-CPARS-2IP	1/8x27	1/8x28	0.99	9/16	0.28
4N-CPARS-4IP	1/4x18	1/4x19	1.32	3/4	0.44
6N-CPARS-6IP	3/8x18	3/8x19	1.41	7/8	0.44
8N-CPARS-8IP	1/2x14	1/2x14	1.74	1-1/16	0.56
12N-CPARS-12IP	3/4x14	3/4x14	1.89	1-1/4	0.62
16N-CPARS-16IP	1x11.5	1x11	2.10	1-5/8	0.72

- 1) RS Fittings are supplied with Gasket seal (Gasket-RS) with male BSP(ISO) Parallel Threads.
It's consists of a fluorocarbon, FKM or Buna-N inner ring bonded to a carbon steel outer ring.

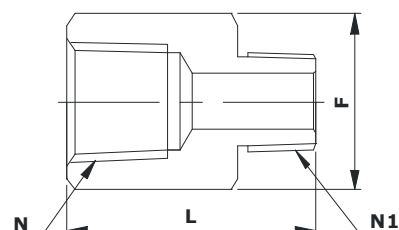

Reducing Adapter__NPT(F) x NPT(M)

COMFIT PRODUCT CODE	NPT FEMALE (N)	NPT MALE (N1)	LENGTH (L)	HEX (F)
	(Dimensions in Inches)			
2-CPRA-1N	1/8x27	1/16x27	1.09	9/16
4-CPRA-1N	1/4x18	1/16x27	1.20	3/4
6-CPRA-1N	3/8x18	1/16x27	1.25	7/8
4-CPRA-2N	1/4x18	1/8x27	1.26	3/4
6-CPRA-2N	3/8x18	1/8x27	1.33	7/8
8-CPRA-2N	1/2x14	1/8x27	1.58	1-1/16
12-CPRA-2N	3/4x14	1/8x27	1.56	1-1/4
16-CPRA-2N	1x11.5	1/8x27	1.81	1-5/8
6-CPRA-4N	3/8x18	1/4x18	1.50	7/8
8-CPRA-4N	1/2x14	1/4x18	1.76	1-1/16
12-CPRA-4N	3/4x14	1/4x18	1.85	1-1/4
16-CPRA-4N	1x11.5	1/4x18	1.96	1-5/8
8-CPRA-6N	1/2x14	3/8x18	1.75	1-1/16
12-CPRA-6N	3/4x14	3/8x18	1.82	1-1/4
16-CPRA-6N	1x11.5	3/8x18	2.00	1-5/8
12-CPRA-8N	3/4x14	1/2x14	2.02	1-1/4
16-CPRA-8N	1x11.5	1/2x14	2.16	1-5/8
16-CPRA-12N	1x11.5	3/4x14	2.17	1-5/8
24-CPRA-12N	1-1/2x11.5	3/4x14	2.48	2-3/8
20-CPRA-16N	1-1/4x11.5	1x11.5	2.53	2-1/8
24-CPRA-16N	1-1/2x11.5	1x11.5	2.65	2-3/8
32-CPRA-16N	2x11.5	1x11.5	2.68	2-7/8

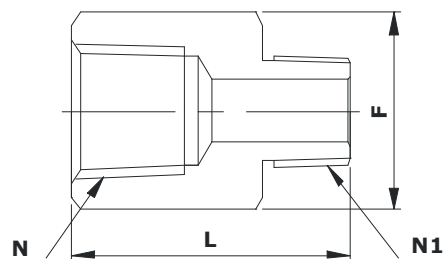

Reducing Adapter__ISO(F) x ISO(M)

COMFIT PRODUCT CODE	ISO(BSPT) Female (N)	ISO(BSPT) Male (N1)	LENGTH (L)	HEX (F)
	(Dimensions in Inches)			
4-CPRA-2IT	1/4x19	1/8x28	1.26	3/4
6-CPRA-4IT	3/8x19	1/4x19	1.50	7/8
8-CPRA-4IT	1/2x14	1/4x19	1.76	1-1/16
8-CPRA-6IT	1/2x14	3/8x19	1.75	1-1/16

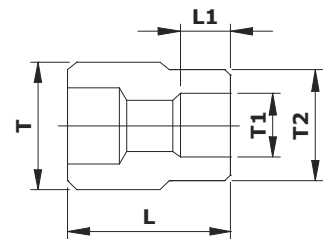

Reducing Adapter ___FT BW or Tube SW x Tube SW

COMFIT PRODUCT CODE	TUBE OD (ØT)	TUBE Socket Size (ØT1)	LENGTH (L)	LENGTH (L1)	(ØT2)
(Dimensions in Inches)					
4TB-CPTRA-2TS	1/4	1/8	0.56	0.10	0.29
6TB-CPTRA-4TS	3/8	1/4	0.75	0.28	0.48
8TB-CPTRA-4TS	1/2	1/4	0.88	0.28	0.50
8TB-CPTRA-6TS	1/2	3/8	0.88	0.31	0.60
12TB-CPTRA-8TS	3/4	1/2	1.12	0.38	0.75
16TB-CPTRA-8TS	1	1/2	1.38	0.38	0.73

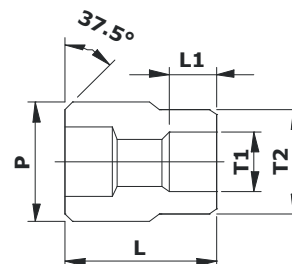

Reducing Adapter ___ Fractional Pipe BW or Pipe SW x Tube SW

COMFIT PRODUCT CODE	TUBE OD (ØP)	TUBE Socket Size (ØT1)	LENGTH (L)	LENGTH (L1)	(ØT2)
(Dimensions in Inches)					
4PB-CPPRA-4TS	1/4	1/4	0.88	0.28	0.48
6PB-CPPRA-6TS	3/8	3/8	1.03	0.31	0.60
6PB-CPPRA-8TS	3/8	1/2	1.00	0.38	0.73
8PB-CPPRA-4TS	1/2	1/4	1.12	0.28	0.48
8PB-CPPRA-6TS	1/2	3/8	1.12	0.31	0.60
8PB-CPPRA-8TS	1/2	1/2	1.19	0.38	0.73
12PB-CPPRA-6TS	3/4	3/8	1.50	0.31	0.60
12PB-CPPRA-8TS	3/4	1/2	1.50	0.38	0.73
12PB-CPPRA-12TS	3/4	3/4	1.50	0.44	1.06
16PB-CPPRA-6TS	1	3/8	1.38	0.31	0.60
16PB-CPPRA-8TS	1	1/2	1.56	0.38	0.73

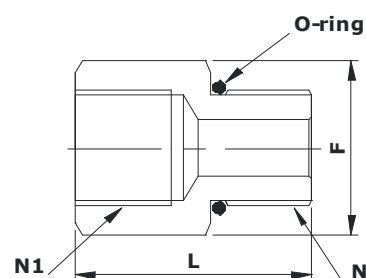

SAE-Adapter UNF(M) x UNF(F)

COMFIT PRODUCT CODE	SAE/MS(UNF) Male (N)	SAE/MS(UNF) Female (N1)	LENGTH (L)	HEX (F)
	(Dimensions in Inches)			
9-CPSA-7SM	9/16x18	7/16x20	1.03	11/16
12-CPSA-7SM	3/4x16	7/16x20	1.09	7/8
17-CPSA-12SM	1-1/16x12	3/4x16	1.00	1-1/4
21-CPSA-17SM	1-5/16x12	1-1/16x12	1.75	1-1/2

- 1) Fittings are supplied with O'ring seal,
 * In Buna-N (Nitrile) as standard suitable for temperature of between
 -35 Deg. F to 250 Deg. F
 * Viton (Fluorocarbon Type A) available upon request for temperature of between
 -15 Deg. F to 400 Deg. F

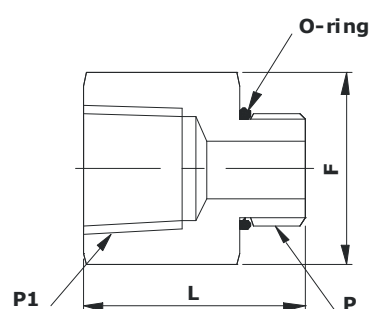
**SAE-Adapter** __ UNF(M) x NPT(F)

COMFIT PRODUCT CODE	SAE/MS((UNF) Male (P)	NPT Female (P1)	LENGTH (L)	HEX (F)
(Dimensions in Inches)				
7SM-CPSA-4N	7/16x20	1/4x18	1.19	3/4
9SM-CPSA-6N	9/16x18	3/8x18	1.26	7/8
12SM-CPSA-8N	3/4x16	1/2x14	1.50	1-1/16
17SM-CPSA-12N	1-1/16x12	3/4x14	1.83	1-1/4
21SM-CPSA-16N	1-5/16x12	1x11.5	1.88	1-5/8

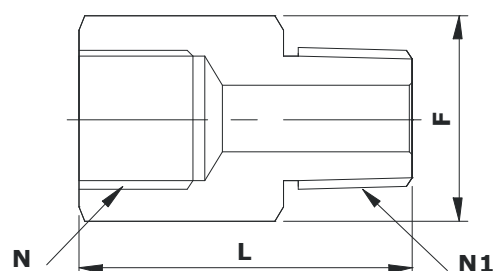

Gauge Adapter ___ ISOP(F) x NPT(M)

COMFIT PRODUCT CODE	ISO(BSPP) PARALLEL FEMALE (N)	NPT MALE (N1)	LENGTH (L)	HEX (F)
	(Dimensions in Inches)			
2RG-CPGA-2N	1/8x28	1/8x27	1.09	9/16
4RG-CPGA-4N	1/4x19	1/4x18	1.08	3/4
6RG-CPGA-6N	3/8x19	3/8x18	1.27	7/8
8RG-CPGA-8N	1/2x14	1/2x14	1.65	1-1/4
16RG-CPGA-16N	1x11	1x11.5	2.28	1-5/8

- 1) Fittings are supplied with RG type gasket.

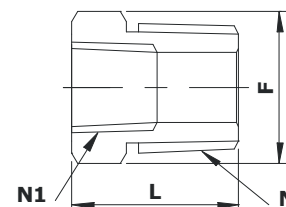

Reducing Bushing ___NPT(M) x NPT(F)

COMFIT PRODUCT CODE	NPT Male (N)	NPT Female (N1)	LENGTH (L)	HEX (F)
	(Dimensions in Inches)			
2-CPRB-1N	1/8x27	1/16x27	1.03	7/16
4-CPRB-1N	1/4x18	1/16x27	1.03	9/16
4-CPRB-2N	1/4x18	1/8x27	1.06	9/16
6-CPRB-1N	3/8x18	1/16x27	0.86	3/4
6-CPRB-2N	3/8x18	1/8x27	0.86	3/4
6-CPRB-4N	3/8x18	1/4x18	1.19	3/4
8-CPRB-2N	1/2x14	1/8x27	1.08	7/8
8-CPRB-4N	1/2x14	1/4x18	1.08	7/8
8-CPRB-6N	1/2x14	3/8x18	1.41	7/8
12-CPRB-2N	3/4x14	1/8x27	1.17	1-1/16
12-CPRB-4N	3/4x14	1/4x18	1.08	1-1/16
12-CPRB-6N	3/4x14	3/8x18	1.08	1-1/16
12-CPRB-8N	3/4x14	1/2x14	1.63	1-1/16
16-CPRB-2N	1x11.5	1/8x27	1.36	1-3/8
16-CPRB-4N	1x11.5	1/4x18	1.37	1-3/8
16-CPRB-6N	1x11.5	3/8x18	1.37	1-3/8
16-CPRB-8N	1x11.5	1/2x14	1.37	1-3/8
16-CPRB-12N	1x11.5	3/4x14	1.85	1-3/8
20-CPRB-8N	1-1/4x11.5	1/2x14	1.46	1-3/4
20-CPRB-12N	1-1/4x11.5	3/4x14	1.47	1-3/4
20-CPRB-16N	1-1/4x11.5	1x11.5	1.94	1-3/4
24-CPRB-8N	1-1/2x11.5	1/2x14	1.61	2-1/8
24-CPRB-12N	1-1/2x11.5	3/4x14	1.61	2-1/8
24-CPRB-16N	1-1/2x11.5	1x11.5	1.61	2-1/8
24-CPRB-20N	1-1/2x11.5	1-1/4	2.31	2-1/8
32-CPRB-8N	2x11.5	1/2x14	1.83	2-3/4
32-CPRB-12N	2x11.5	3/4x14	1.83	2-3/4
32-CPRB-16N	2x11.5	1x11.5	1.83	2-3/4
32-CPRB-20N	2x11.5	1-1/4x11.5	1.83	2-3/4
32-CPRB-24N	2x11.5	1-1/2x11.5	1.83	2-3/4

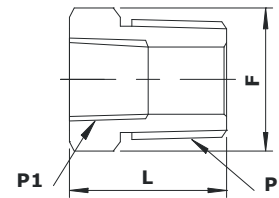

Reducing Bushing___ISO T(M) x ISO T (F)

COMFIT PRODUCT CODE	ISO Male (P)	ISO Female (P1)	LENGTH (L)	HEX (F)
(Dimensions in Inches)				
4-CPRB-2RT	1/4x19	1/8x28	1.06	9/16
6-CPRB-4RT	3/8x19	1/4x19	1.19	3/4
8-CPRB-4RT	1/2x14	1/4x19	1.08	7/8
8-CPRB-6RT	1/2x14	3/8x19	1.41	7/8

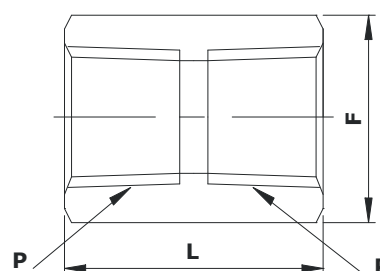

Hex Coupling ___NPT(F) x NPT(F)

COMFIT PRODUCT CODE	NPT Female (P)	LENGTH (L)	HEX (F)
(Dimensions in Inches)			
1N-CPHC	1/16x27	0.75	1/2
2N-CPHC	1/8x27	0.81	9/16
4N-CPHC	1/4x18	1.19	3/4
6N-CPHC	3/8x18	1.31	7/8
8N-CPHC	1/2x14	1.56	1-1/16
12N-CPHC	3/4x14	1.62	1-1/4
16N-CPHC	1x11.5	2.00	1-5/8
20N-CPHC	1-1/4x11.5	2.38	2-1/8
24N-CPHC	1-1/2x11.5	2.62	2-3/8
32N-CPHC	2x11.5	2.62	2-7/8

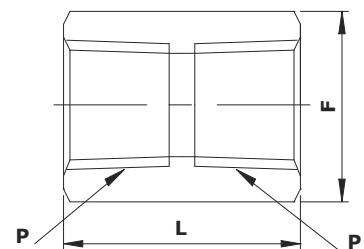

Hex Coupling__ISO(T(F)) x ISO(T(F))

COMFIT PRODUCT CODE	ISO(BSPT) Female (P)	LENGTH (L)	HEX (F)
(Dimensions in Inches)			
2IT-CPHC	1/8x28	0.81	9/16
4IT-CPHC	1/4x19	1.19	3/4
6IT-CPHC	3/8x19	1.31	7/8
8IT-CPHC	1/2x14	1.56	1-1/16

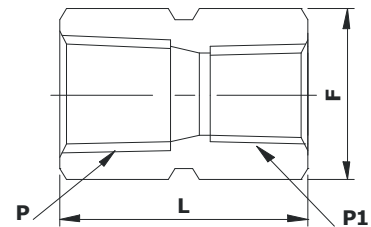

Hex Reducing Coupling ___NPT(F) x NPT(F)

COMFIT PRODUCT CODE	NPT Female (P)	NPT Female (P1)	LENGTH (L)	HEX (F)
	(Dimensions in Inches)			
2-CPHRC-1N	1/8x27	1/16x27	0.75	9/16
2- CPHRC-4N	1/8x27	1/4	1.22	3/4
4- CPHRC-1N	1/4x18	1/16x27	0.92	3/4
6- CPHRC-1N	3/8x18	1/16x27	0.95	7/8
6- CPHRC-2N	3/8x18	1/8x27	1.03	7/8
6- CPHRC-4N	3/8x18	1/4x18	1.38	7/8
8- CPHRC-2N	1/2x14	1/8x27	1.56	9/16
8- CPHRC-4N	1/2x14	1/4x18	1.75	1-1/16
8- CPHRC-6N	1/2x14	3/8x18	1.78	1-1/16
12- CPHRC-2N	3/4x14	1/8x27	1.39	1-1/4
12- CPHRC-4N	3/4x14	1/4x18	1.81	1-1/4
12- CPHRC-6N	3/4x14	3/8x18	1.69	1-1/4
12- CPHRC-8N	3/4x14	1/2x14	2.06	1-1/4
16- CPHRC-2N	1x11.5	1/8x27	1.44	1-5/8
16- CPHRC-4N	1x11.5	1/4x18	1.63	1-5/8
16- CPHRC-6N	1x11.5	3/8x18	1.63	1-5/8
16- CPHRC-8N	1x11.5	1/2x14	2.19	1-5/8
16- CPHRC-12N	1x11.5	3/4x14	2.25	1-5/8
20- CPHRC-16N	1-1/4x11.5	1x11.5	2.41	2-1/8
24- CPHRC-16N	1-1/2x11.5	1x11.5	2.38	2-3/8
32- CPHRC-16N	2x11.5	1x11.5	2.58	2-7/8

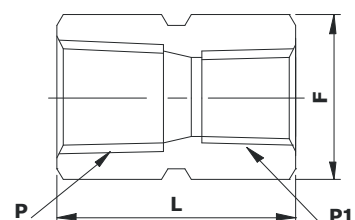

Hex Reducing Coupling ___ ISOT(F) x ISOT(F)

COMFIT PRODUCT CODE	ISO(BSPT) Female (P)	ISO(BSPT) Female (P1)	LENGTH (L)	HEX (F)
	(Dimensions in Inches)			
6-CPHRC-4IT	3/8x19	1/4x19	1.38	7/8
8-CPHRC-4IT	1/2x14	1/4x19	1.75	1-1/16
8-CPHRC-6IT	1/2x14	3/8x19	1.78	1-1/16

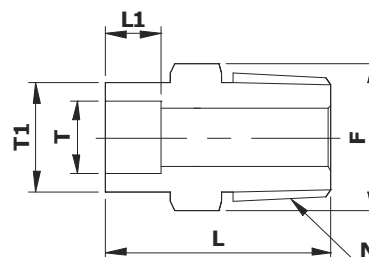

Male Connector ___ FT SW x NPT(M)

COMFIT PRODUCT CODE	TUBE OD (ØT)	NPT MALE (N)	LENGTH (L)	(ØT1)	LENGTH (L1)	HEX (F)
(Dimensions in Inches)						
4TS-CPMC-4N	1/4	1/4	1.25	0.48	0.28	9/16
6TS-CPMC-4N	3/8	1/4	1.25	0.60	0.31	5/8
6TS-CPMC-6N	3/8	3/8	1.25	0.60	0.31	11/16
6TS-CPMC-8N	3/8	1/2	1.47	0.60	0.31	7/8
8TS-CPMC-4N	1/2	1/4	1.31	0.73	0.38	3/4
8TS-CPMC-6N	1/2	3/8	1.31	0.73	0.38	3/4
8TS-CPMC-8N	1/2	1/2	1.53	0.73	0.38	7/8

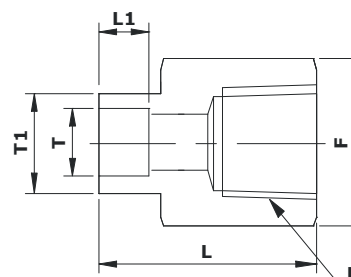

Female Connector ___ FT SW x NPT(F)

COMFIT PRODUCT CODE	TUBE OD (ØT)	NPT FEMALE (N)	LENGTH (L)	(ØT1)	LENGTH (L1)	HEX (F)
(Dimensions in Inches)						
2TS-CPFC-2N	1/8	1/8	0.83	0.29	0.10	9/16
4TS-CPFC-2N	1/4	1/8	1.05	0.48	0.28	9/16
4TS-CPFC-4N	1/4	1/4	1.18	0.48	0.28	3/4
6TS-CPFC-4N	3/8	1/4	1.24	0.60	0.31	3/4
8TS-CPFC-6N	1/2	3/8	1.36	0.73	0.38	7/8
8TS-CPFC-8N	1/2	1/2	1.59	0.73	0.38	1-1/16
10TS-CPFC-8N	5/8	1/2	1.65	0.92	0.41	1-1/16
12TS-CPFC-12N	3/4	3/4	1.73	1.04	0.44	1-1/4

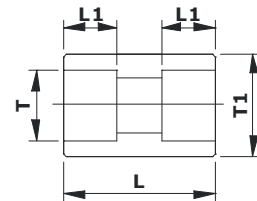

Tube Union ___FT SW Ends

COMFIT PRODUCT CODE	TUBE OD (ØT)	LENGTH (L)	(ØT1)	LENGTH (L1)
(Dimensions in Inches)				
4TS-CPTU	1/4	0.75	0.48	0.28
6TS-CPTU	3/8	0.88	0.60	0.31
8TS-CPTU	1/2	1.06	0.73	0.38
10TS-CPTU	5/8	1.19	0.92	0.41
12TS-CPTU	3/4	1.31	1.04	0.44
16TS-CPTU	1	1.44	1.36	0.62

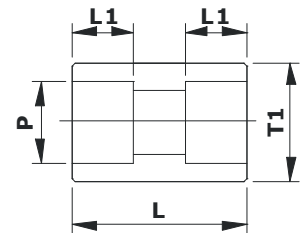

Pipe Union ___ Pipe SW

COMFIT PRODUCT CODE	PIPE SIZE (ØP)	LENGTH (L)	(ØT1)	LENGTH (L1)
(Dimensions in Inches)				
4PS-CPPU	1/4	1.06	0.98	0.38
6PS-CPPU	3/8	1.12	1.11	0.44
8PS-CPPU	1/2	1.12	1.36	0.50
12PS-CPPU	3/4	1.75	1.48	0.62
16PS-CPPU	1	1.75	1.86	0.62

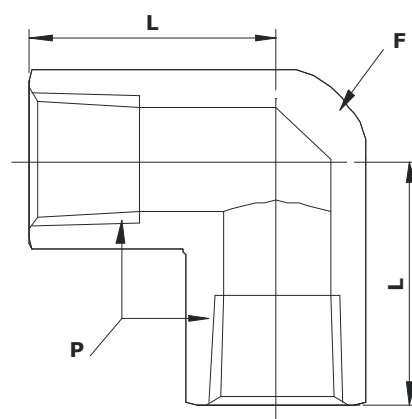

Female Elbow ___NPT(F) x NPT(F)

COMFIT PRODUCT CODE	NPT Female (P)	LENGTH (L)	HEX (F)
(Dimensions in Inches)			
1N-CPFE	1/16x27	0.50	7/16
2N-CPFE	1/8x27	1.04	9/16
4N-CPFE	1/4x18	1.17	3/4
6N-CPFE	3/8x18	1.42	7/8
8N-CPFE	1/2x14	1.56	1-1/16
12N-CPFE	3/4x14	1.92	1-1/4
16N-CPFE	1x11.5	1.91	1-5/8
20N-CPFE	1-1/4x11.5	1.70	1-7/8
24N-CPFE	1-1/2x11.5	2.08	2-1/2

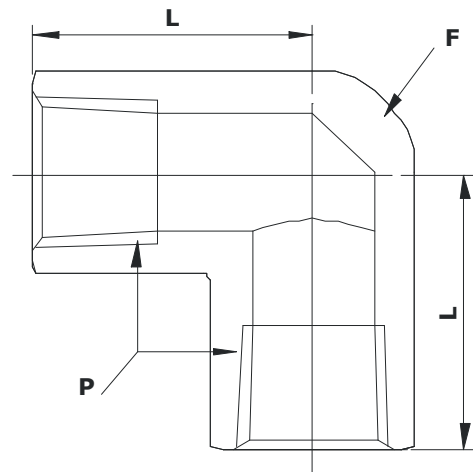

Female Elbow ___ ISOT(F) x ISOT(F)

COMFIT PRODUCT CODE	ISO(BSPT) Female (P) (Dimensions in Inches)	LENGTH (L)	HEX (F)
4IT-CPFE	1/4x19	1.17	3/4
6IT-CPFE	3/8x19	1.42	7/8
8IT-CPFE	1/2x14	1.56	1-1/16

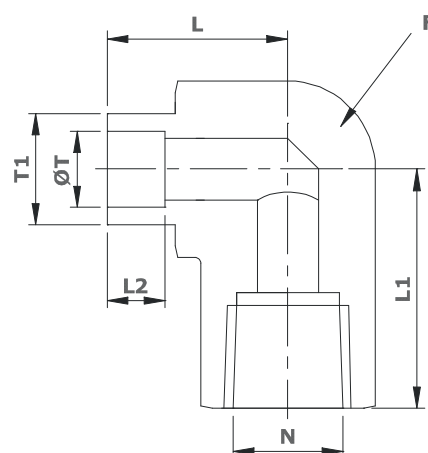

Female Elbow ___ FT SW x NPT(F)

COMFIT PRODUCT CODE	TUBE OD (ØT)	NPT FEMALE (N)	LENGTH (L)	LENGTH (L1)	(ØT1)	LENGTH (L2)	HEX (F)
(Dimensions in Inches)							
4TS-CPFE-4N	1/4	1/4	0.90	1.17	0.48	0.28	3/4
6TS-CPFE-4N	3/8	1/4	0.99	1.17	0.60	0.31	3/4
6TS-CPFE-8N	3/8	1/2	1.13	1.56	0.60	0.31	1-1/16
8TS-CPFE-8N	1/2	1/2	1.19	1.56	0.73	0.38	1-1/16

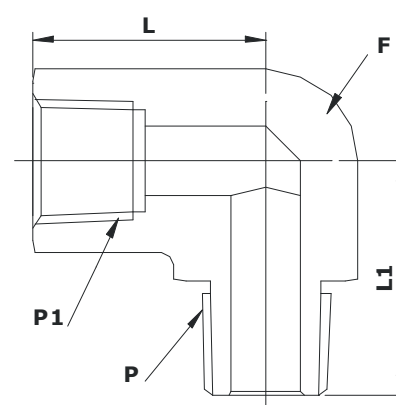

Street Elbow ___NPT(M) x NPT(F)

COMFIT PRODUCT CODE	NPT Male (P)	NPT Female (P1)	LENGTH (L)	LENGTH (L1)	HEX (F)
(Dimensions in Inches)					
1-CPSE-1N	1/16x27	1/16x27	0.86	0.88	7/16
2-CPSE-2N	1/8x27	1/8x27	1.04	0.87	9/16
4-CPSE-4N	1/4x18	1/4x18	1.17	1.17	3/4
6-CPSE-6N	3/8x18	3/8x18	1.42	1.26	7/8
8-CPSE-8N	1/2x14	1/2x14	1.56	1.56	1-1/16
12-CPSE-12N	3/4x14	3/4x14	1.92	1.67	1-1/4
16-CPSE-16N	1x11.5	1x11.5	1.91	1.94	1-5/8
20-CPSE-20N	1-1/4x11.5	1-1/4x11.5	1.91	2.38	1-7/8

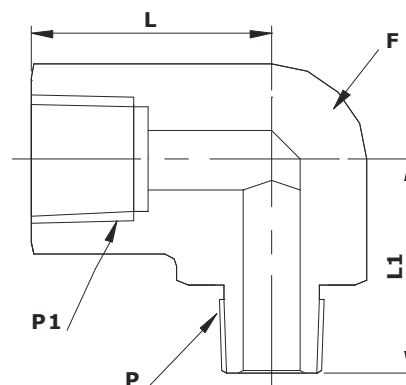

Reducing Street Elbow ___ NPT(M) x NPT(F)

COMFIT PRODUCT CODE	NPT Male (P)	NPT Female (P1)	LENGTH (L)	LENGTH (L1)	HEX (F)
	(Dimensions in Inches)				
2-CPRSE-1N	1/8x27	1/16x27	1.04	0.87	7/16
4-CPRSE-1N	1/4x18	1/16x27	0.66	1.09	9/16
4-CPRSE-2N	1/4x18	1/8x27	1.17	1.00	9/16
6-CPRSE-1N	3/8x18	1/16x27	0.88	1.09	11/16
6-CPRSE-2N	3/8x18	1/8x27	0.88	1.22	11/16
6-CPRSE-4N	3/8x18	1/4x18	1.42	1.26	3/4
8-CPRSE-2N	1/2x14	1/8x27	0.95	1.47	7/8
8-CPRSE-4N	1/2x14	1/4x18	1.56	1.38	7/8
8-CPRSE-6N	1/2x14	3/8x18	1.56	1.38	7/8
12-CPRSE-2N	3/4x14	1/8x27	1.00	1.59	1-1/16
12-CPRSE-4N	3/4x14	1/4x18	1.00	1.59	1-1/16
12-CPRSE-6N	3/4x14	3/8x18	1.23	1.59	1-1/16
12-CPRSE-8N	3/4x14	1/2x14	1.23	1.59	1-1/16
16-CPRSE-2N	1x11.5	1/8x27	1.63	1.97	1-3/8
16-CPRSE-4N	1x11.5	1/4x18	1.63	1.97	1-3/8
16-CPRSE-6N	1x11.5	3/8x18	1.50	1.97	1-3/8
16-CPRSE-8N	1x11.5	1/2x14	1.63	1.97	1-3/8
16-CPRSE-12N	1x11.5	3/4x14	1.36	1.97	1-3/8

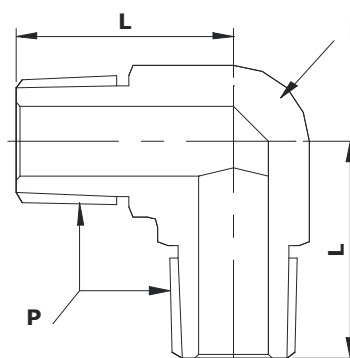

Male Elbow ___ NPT(M) x NPT(M)

COMFIT PRODUCT CODE	NPT Female (P)	LENGTH (L)	HEX (F)
	(Dimensions in Inches)		
1N-CPME	1/16x27	0.66	7/16
2N-CPME	1/8x27	0.88	7/16
4N-CPME	1/4x18	1.05	9/16
6N-CPME	3/8x18	1.17	11/16
8N-CPME	1/2x14	1.45	7/8
12N-CPME	3/4x14	1.59	1-1/16
16N-CPME	1x11.5	1.97	1-3/8

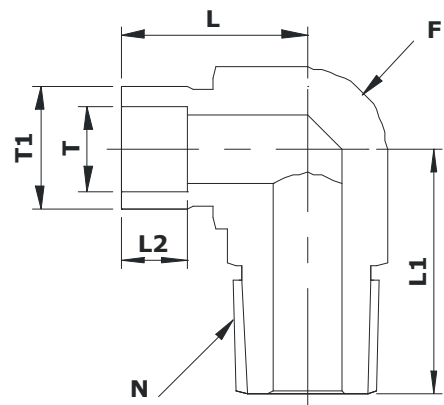

Male Elbow ___FT SW x NPT(M)

COMFIT PRODUCT CODE	TUBE OD (ØT)	NPT MALE (N)	LENGTH (L)	LENGTH (L1)	(ØT1)	LENGTH (L2)	HEX (F)
(Dimensions in Inches)							
4TS-CPME-4N	1/4	1/4	0.79	1.05	0.48	0.28	9/16
6TS-CPME-4N	3/8	1/4	1.04	1.05	0.62	0.31	9/16
6TS-CPME-6N	3/8	3/8	0.97	1.17	0.60	0.31	11/16
6TS-CPME-8N	3/8	1/2	1.02	1.45	0.60	0.31	7/8
8TS-CPME-8N	1/2	1/2	1.08	1.45	0.73	0.38	7/8
12TS-CPME-12N	3/4	3/4	1.56	1.56	1.12	0.44	1-1/16

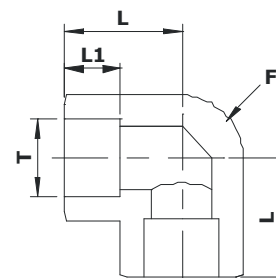

Union Elbow ___ FT SW Ends

COMFIT PRODUCT CODE	TUBE OD (ØT)	LENGTH (L)	LENGTH (L1)	HEX (F)
(Dimensions in Inches)				
4TS-CPUE	1/4	0.86	0.28	7/16
6TS-CPUE	3/8	1.04	0.31	9/16
8TS-CPUE	1/2	1.17	0.38	11/16
10TS-CPUE	5/8	1.42	0.41	13/16
12TS-CPUE	3/4	1.56	0.44	1
16TS-CPUE	1	1.92	0.62	1-1/4

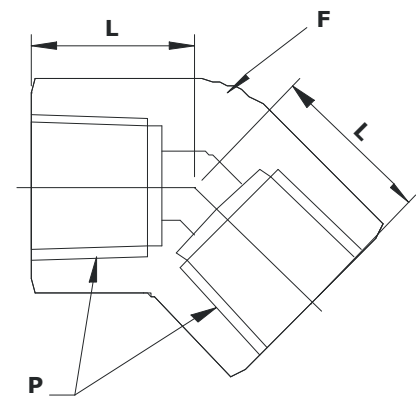

45° Female Elbow ___ NPT(F) x NPT(F)

COMFIT PRODUCT CODE	NPT Female (P)	LENGTH (L)	HEX (F)
(Dimensions in Inches)			
1N-CP45FE	1/16x27	0.47	7/16
2N-CP45FE	1/8x27	0.47	7/16
4N-CP45FE	1/4x18	0.69	9/16
6N-CP45FE	3/8x18	0.75	11/16
8N-CP45FE	1/2x14	0.94	7/8
12N-CP45FE	3/4x14	1.00	1-1/16
16N-CP45FE	1x11.5	1.19	1-3/8

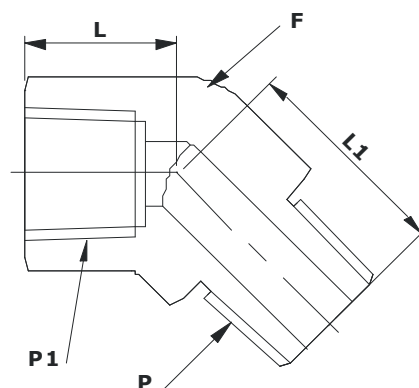

45° Street Elbow ___ NPT(M) x NPT(F)

COMFIT PRODUCT CODE	NPT Male (P)	NPT Female (P1)	LENGTH (L)	LENGTH (L1)	HEX (F)
(Dimensions in Inches)					
1N-CP45SE	1/16x27	1/16x27	0.47	0.66	7/16
2N-CP45SE	1/8x27	1/8x27	0.47	0.72	9/16
4N-CP45SE	1/4x18	1/4x18	0.63	1.05	3/4
6N-CP45SE	3/8x18	3/8x18	0.72	1.06	7/8
8N-CP45SE	1/2x14	1/2x14	0.91	1.34	1-1/16
12N-CP45SE	3/4x14	3/4x14	0.97	1.38	1-1/4
16N-CP45SE	1x11.5	1x11.5	1.13	1.72	1-5/8

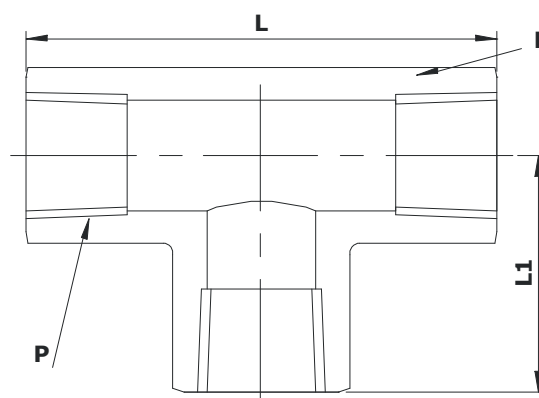

Female Tee ___ NPT(F) x NPT(F) x NPT(F)

COMFIT PRODUCT CODE	NPT Female (P)	LENGTH (L)	LENGTH (L1)	HEX (F)
(Dimensions in Inches)				
1N-CPFT	1/16x27	1.00	0.50	7/16
2N-CPFT	1/8x27	2.08	1.04	9/16
4N-CPFT	1/4x18	2.34	1.17	3/4
6N-CPFT	3/8x18	2.84	1.42	7/8
8N-CPFT	1/2x14	3.12	1.56	1-1/16
12N-CPFT	3/4x14	3.84	1.92	1-1/4
16N-CPFT	1x11.5	3.82	1.91	1-5/8
20N-CPFT	1-1/4x27	3.40	1.70	1-7/8
24N-CPFT	1-1/2x27	4.16	2.08	2-1/2

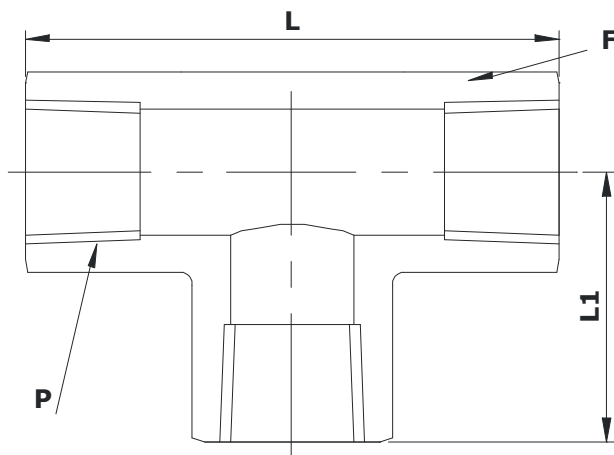

Female Tee ___ ISOT(F) x ISOT(F) x ISOT(F)

COMFIT PRODUCT CODE	NPT Female (P)	LENGTH (L)	LENGTH (L1)	HEX (F)
(Dimensions in Inches)				
4IT-CPFT	1/4x19	2.34	1.17	3/4
6IT-CPFT	3/8x19	2.84	1.42	7/8
8IT-CPFT	1/2x14	3.12	1.56	1-1/16

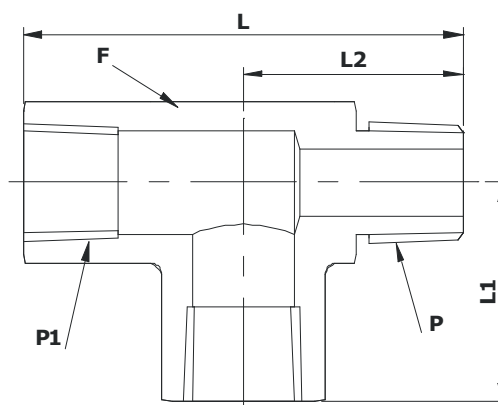

Street Tee ___NPT(F) xNPT(M) x NPT(F)

COMFIT PRODUCT CODE	NPT Male (P)	NPT Female (P1)	LENGTH (L)	LENGTH (L1)	LENGTH (L2)	HEX (F)
(Dimensions in Inches)						
1N-CPST	1/16x27	1/16x27	1.22	0.50	0.72	7/16
2N-CPST	1/8x27	1/8x27	1.91	1.04	0.87	9/16
4N-CPST	1/4x18	1/4x18	2.34	1.17	1.17	3/4
6N-CPST	3/8x18	3/8x18	2.68	1.42	1.26	7/8
8N-CPST	1/2x14	1/2x14	3.12	1.56	1.56	1-1/16
12N-CPST	3/4x14	3/4x14	2.95	1.36	1.59	1-1/4
16N-CPST	1x11.5	1x11.5	3.60	1.63	1.97	1-5/8

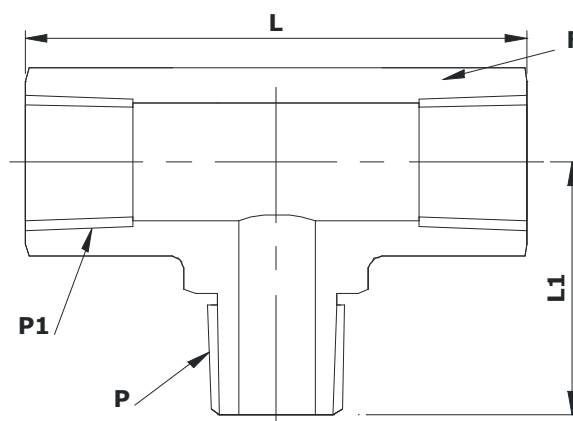

Branch Tee__NPT(F) x NPT(F) x NPT(M)

COMFIT PRODUCT CODE	NPT Male (P)	NPT Female (P1)	LENGTH (L)	LENGTH (L1)	HEX (F)
(Dimensions in Inches)					
1N-CPBT	1/16x27	1/16x27	1.00	0.72	7/16
2N-CPBT	1/8x27	1/8x27	2.08	0.87	9/16
4N-CPBT	1/4x18	1/4x18	2.34	1.17	3/4
6N-CPBT	3/8x18	3/8x18	2.84	1.26	7/8
8N-CPBT	1/2x14	1/2x14	3.12	1.56	1-1/16
12N-CPBT	3/4x14	3/4x14	2.72	1.59	1-1/4
16N-CPBT	1x11.5	1x11.5	3.26	1.97	1-5/8

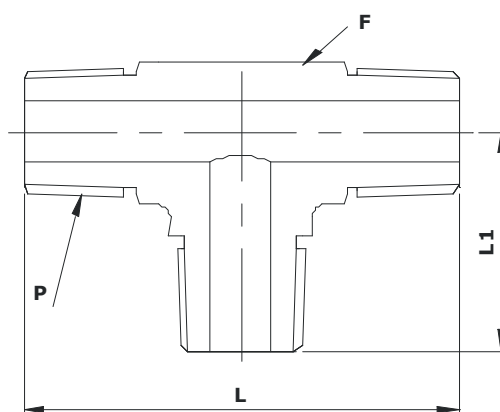

Male Tee ___NPT(M) x NPT(M) x NPT(M)

COMFIT PRODUCT CODE	NPT Male (P)	LENGTH (L)	LENGTH (L1)	HEX (F)
(Dimensions in Inches)				
1N-CPMT	1/16x27	1.44	0.72	7/16
2N-CPMT	1/8x27	1.76	0.88	7/16
4N-CPMT	1/4x18	2.10	1.05	9/16
6N-CPMT	3/8x18	2.34	1.17	11/16
8N-CPMT	1/2x14	2.90	1.45	7/8
12N-CPMT	3/4x14	3.18	1.59	1-1/16
16N-CPMT	1x11.5	3.94	1.97	1-3/8
20N-CPMT	1-1/4x11.5	4.44	2.22	1-5/8
24N-CPMT	1-1/2x11.5	5.28	2.64	1-7/8

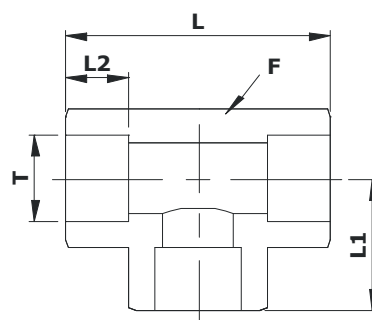

Union Tee ___FT SW Ends

COMFIT PRODUCT CODE	TUBE OD (ØT)	LENGTH (L)	LENGTH (L1)	LENGTH (L2)	HEX (F)
(Dimensions in Inches)					
2TS-CPUT	1/8	1.18	0.56	0.10	7/16
4TS-CPUT	1/4	1.72	0.86	0.28	9/16
6TS-CPUT	3/8	2.08	1.04	0.31	9/16
8TS-CPUT	1/2	2.34	1.17	0.38	11/16
10TS-CPUT	5/8	2.84	1.42	0.41	13/16
12TS-CPUT	3/4	3.12	1.56	0.44	1
16TS-CPUT	1	3.84	1.92	0.62	1-1/4

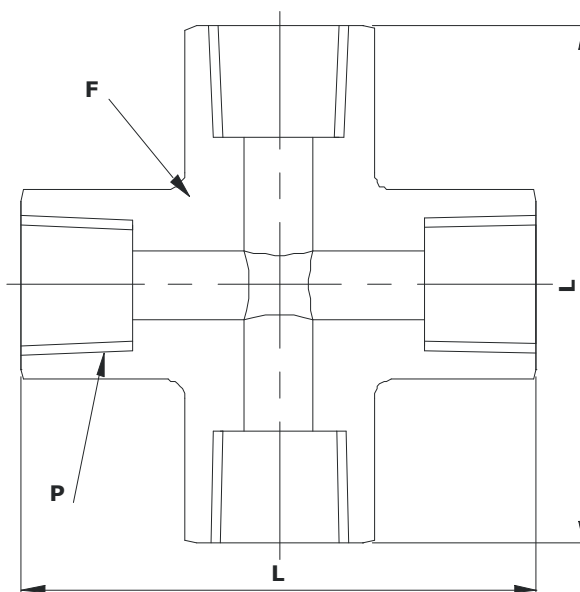

Female Cross ___ NPT(F) x 4 Sides

COMFIT PRODUCT CODE	NPT Female (P)	LENGTH (L)	HEX (F)
(Dimensions in Inches)			
1N-CPFC	1/16x27	1.00	7/16
2N-CPFC	1/8x27	2.08	9/16
4N-CPFC	1/4x18	2.34	3/4
6N-CPFC	3/8x18	2.84	7/8
8N-CPFC	1/2x14	3.12	1-1/16
12N-CPFC	3/4x14	3.84	1-1/4
16N-CPFC	1x11.5	3.82	1-5/8

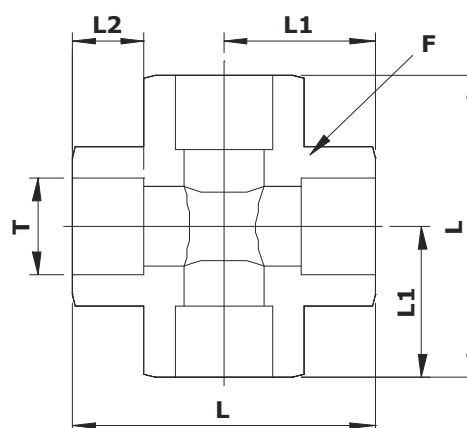

Union Cross ___FT SW Ends

COMFIT PRODUCT CODE	TUBE OD (ØT)	LENGTH (L)	LENGTH (L1)	LENGTH (L2)	HEX (F)
(Dimensions in Inches)					
4TS-CPUC	1/4	1.72	0.86	0.28	7/16
6TS-CPUC	3/8	2.08	1.04	0.31	9/16
8TS-CPUC	1/2	2.34	1.17	0.38	11/16
12TS-CPUC	3/4	3.12	1.56	0.44	1
16TS-CPUC	1	3.84	1.92	0.62	1-1/4

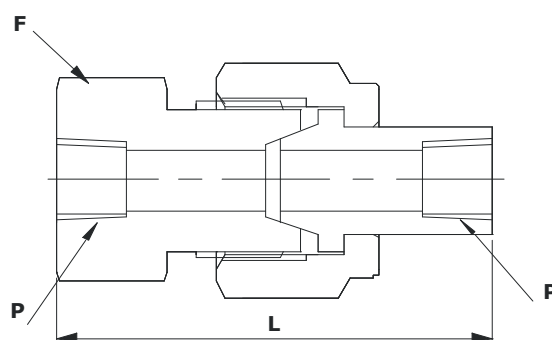

Union Ball Joint ___ NPT(F) x NPT(F)

COMFIT PRODUCT CODE	NPT Female (P)	LENGTH (L)	HEX (F)
(Dimensions in Inches)			
2N-CPUBJ	1/8x27	1.81	1-1/8
4N-CPUBJ	1/4x18	2.34	1-3/8
6N-CPUBJ	3/8x18	2.50	1-1/2
8N-CPUBJ	1/2x14	2.69	1-3/4
12N-CPUBJ	3/4x14	3.12	2
16N-CPUBJ	1x11.5	3.56	2-1/2

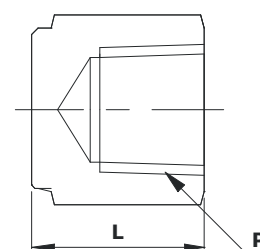

Hex Female Pipe Cap ___NPT(F)

COMFIT PRODUCT CODE	NPT Female (P)	LENGTH (L)
	(Dimensions in Inches)	
1N-CPHFPC	1/16x27	0.50
2N-CPHFPC	1/8x27	0.75
4N-CPHFPC	1/4x18	0.91
6N-CPHFPC	3/8x18	1.03
8N-CPHFPC	1/2x14	1.34
12N-CPHFPC	3/4x14	1.44
16N-CPHFPC	1x11.5	1.62
20N-CPHFPC	1-1/4x11.5	2.00
24N-CPHFPC	1-1/2x11.5	2.06
32N-CPHFPC	2x11.5	2.17

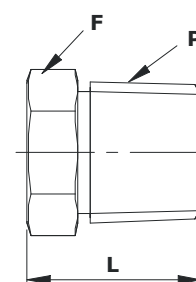

Hex Male Plug NPT(M)

COMFIT PRODUCT CODE	NPT Male (P)	LENGTH (L)	HEX (F)
	(Dimensions in Inches)		
1N-CPHMP	1/16x27	0.75	5/16
2N-CPHMP	1/8x27	0.75	7/16
4N-CPHMP	1/4x18	0.96	9/16
6N-CPHMP	3/8x18	0.99	11/16
8N-CPHMP	1/2x14	1.21	7/8
12N-CPHMP	3/4x14	1.21	1-1/16
16N-CPHMP	1x11.5	1.50	1-3/8
20N-CPHMP	1-1/4x11.5	1.59	1-3/4
24N-CPHMP	1-1/2x11.5	1.74	2-1/8
32N-CPHMP	2x11.5	1.96	2-3/4

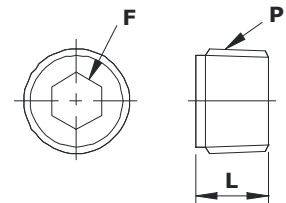
**Allen Plug__NPT(M)**

COMFIT PRODUCT CODE	NPT Male (P)	LENGTH (L)	HEX (F)
(Dimensions in Inches)			
1N-CPAP	1/16x27	0.30	5/32
2N-CPAP	1/8x27	0.30	3/16
4N-CPAP	1/4x18	0.47	1/4
6N-CPAP	3/8x18	0.47	5/16

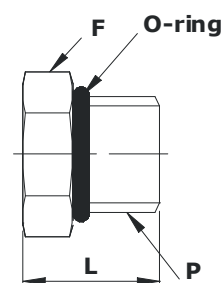

Hex SAE Plug ___ UNF(M)

COMFIT PRODUCT CODE	SAE/MS Male (P)	LENGTH (L)	HEX (F)
	(Dimensions in Inches)		
4SM-CPHSP	7/16x20	0.67	9/16
6SM-CPHSP	9/16x18	0.73	11/16
8SM-CPHSP	3/4x16	0.08	7/8
12SM-CPHSP	1-1/16x12	1.09	1-1/4
16SM-CPHSP	1-5/16x12	1.13	1-1/2

- 1) Fittings are supplied with O'ring seal,
* In Buna-N (Nitrile) as standard & Viton-optional.

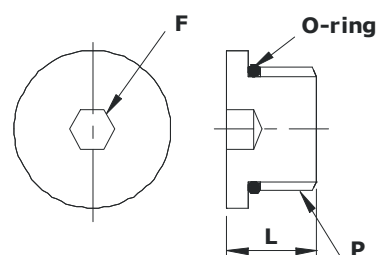

Allen SAE Plug__UNF(M)

COMFIT PRODUCT CODE	SAE/MS Male (P)	LENGTH (L)	HEX (F)
	(Dimensions in Inches)		
4U-CPASP	7/16x20	0.47	3/16
6U-CPASP	9/16x18	0.50	1/4
8U-CPASP	3/4x16	0.58	5/16
12U-CPASP	1-1/16x12	0.77	9/16
16U-CPASP	1-5/16x12	0.77	5/8

- 1) Fittings are supplied with O’ring seal,
 * In Buna-N (Nitrile) as standard & Viton-optional.

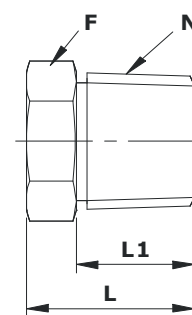

Hex Pipe Plug__ISOT(F)

COMFIT PRODUCT CODE	ISO(BSPT) MALE (N)	LENGTH (L)	LENGTH (L1)	HEX (F)
(Dimensions in Inches)				
2IT-CPHPP	1/8x28	0.59	0.38	7/16
4IT-CPHPP	1/4x19	0.81	0.56	9/16
6IT-CPHPP	3/8x19	0.81	0.56	11/16
8IT-CPHPP	1/2x14	1.06	0.75	7/8
12IT-CPHPP	3/4x14	0.13	0.75	1-1/16
16IT-CPHPP	1x11	1.31	0.94	1-3/8

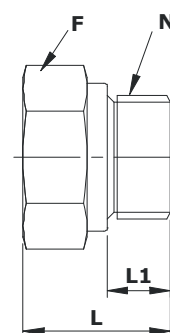

Hex Pipe Plug-RS__ISOP(M)

COMFIT PRODUCT CODE	ISO MALE (N)	LENGTH (L)	LENGTH (L1)	HEX (F)
	(Dimensions in Inches)			
2IP-CPHPPRS	1/8x28	0.55	0.28	9/16
4IP-CPHPPRS	1/4x19	0.78	0.44	3/4
6IP-CPHPPRS	3/8x19	0.78	0.44	7/8
8IP-CPHPPRS	1/2x14	0.99	0.56	1-1/16
12IP-CPHPPRS	3/4x14	1.13	0.63	1-1/4
16IP-CPHPPRS	1x11	1.21	0.72	1-5/8

- 1) RS Fittings are supplied with Gasket seal (Gasket-RS) with male BSP(ISO) Parallel Threads. It's consists of a fluorocarbon, FKM or Buna-N inner ring bonded to a carbon steel outer ring.

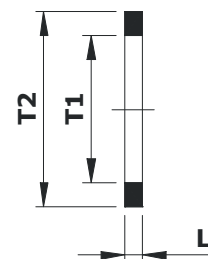

Gasket-RS

COMFIT PRODUCT CODE	(ØT1)	(ØT2)	LENGTH (L)
	(Dimensions in Inches)		
2-CPRSG	0.41	0.63	0.08
4-CPRSG	0.54	0.81	0.08
6-CPRSG	0.68	0.94	0.08
8-CPRSG	0.85	1.13	0.10
12-CPRSG	1.06	1.38	0.10
16-CPRSG	1.33	1.96	0.10

- Gasket-RS provides a seal with ISO parallel threads. The gasket consists of a Viton or Buna inner ring bonded to a carbon steel outer ring. (A Viton inner ring bonded to a stainless steel outer ring is available on special order)
- Gasket-RS cannot be used with RP fittings. (This gasket can be used with `RS' type fittings)

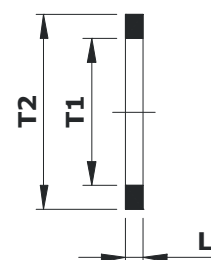

Gasket-RP

COMFIT PRODUCT CODE	(ØT1)	(ØT2)	LENGTH (L)
	(Dimensions in Inches)		
2-CPRPG	0.39	0.59	0.04
4-CPRPG	0.53	0.74	0.06
6-CPRPG	0.67	0.90	0.06
8-CPRPG	0.84	1.06	0.06
12-CPRPG	1.05	1.30	0.08
16-CPRPG	1.32	1.57	0.08

- Gasket-RP provides a seal with ISO parallel threads. The standard material is copper.
- The Gasket-RP can also be used with the RS fitting.

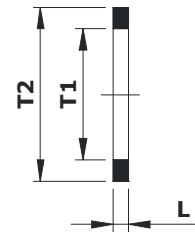

Gasket-RG

COMFIT PRODUCT CODE	(ØT1)	(ØT2)	LENGTH (L)
	(Dimensions in Inches)		
4-CPRGG	0.30	0.42	0.07
6-CPRGG	0.34	0.56	0.08
8-CPRGG	0.36	0.70	0.10

- Gasket-RG provides a seal on pressure gauges equipped with ISO parallel male threads. The standard material is copper.

B-TEK